

Shree Constructions

BUILDING CONTRACTOR | FLAT PROMOTER | ARCHITECTS



SALIENT FEATURES



**Project
Size - 2 grounds**



**Premium Layout
with 24 feet Roads**



**Located within
the Vijaya nagar**



**Good
Ground Water**



**Integrated
community with
Stilt floor**



**Black / Concrete
top Roads**



**Integrated secured
community with
24/7 CCTV Surveillance**

**1, 2 & 3 BHK
FLAT FOR SALE**

@ VIJAYANAGAR
200 m from main road & Bus stop
Manimagalam road,
Varadharajapuram
Stilt plus three floors
Total Flats : 11

Contact us: 9566220055 , 9500123824

Website: www.shreeconstructions.com



First floor plan

Second and Third floor plan

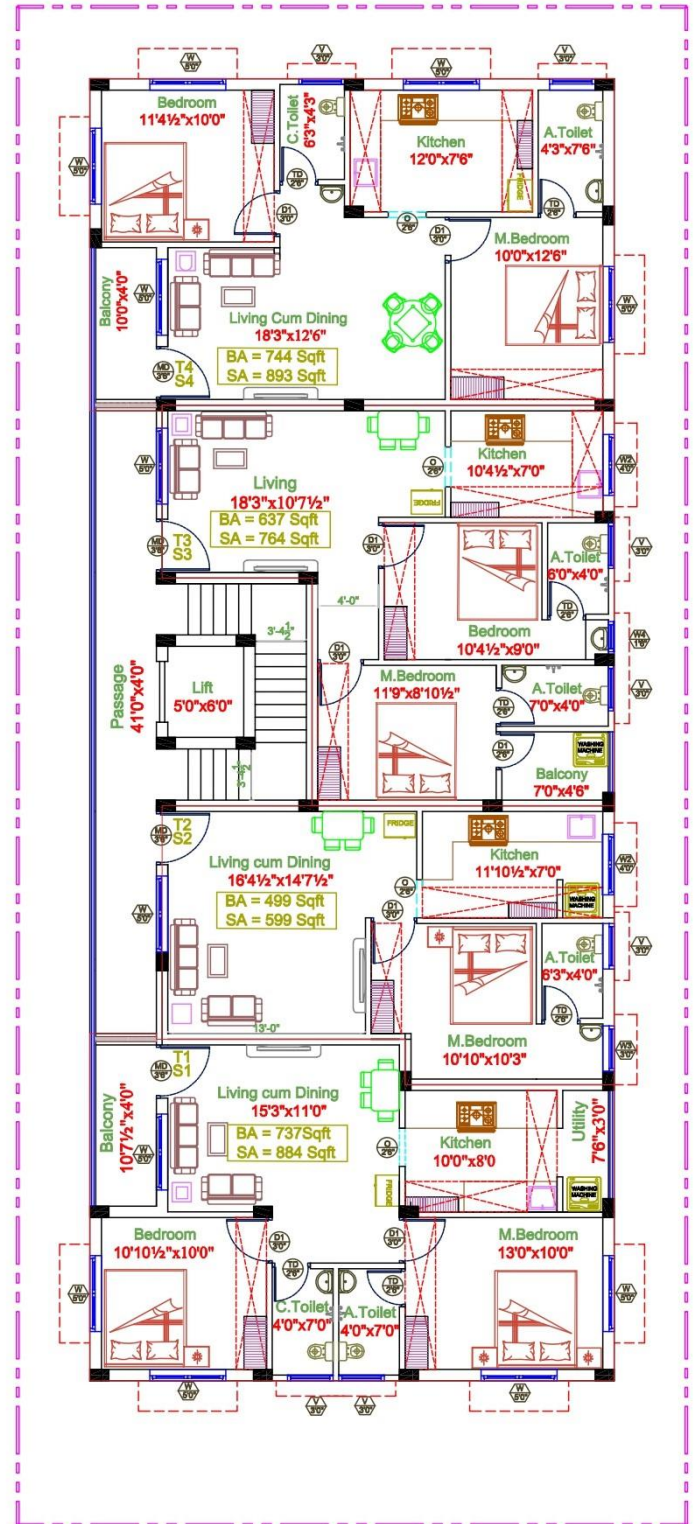
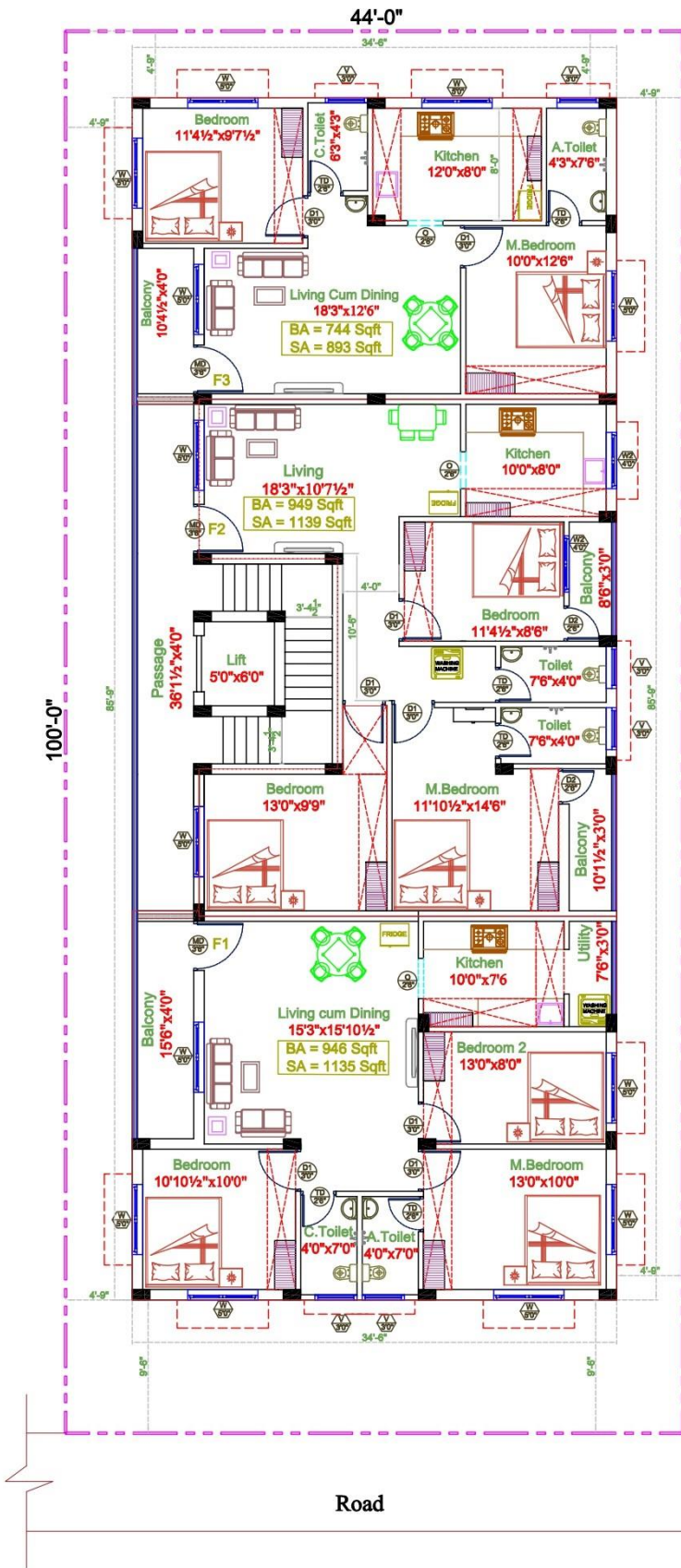

AREA STATEMENT

FLAT	S A	TYPE	FACING
F1	1135	3BHK	NORTH
F2,	1139	3BHK	NORTH
F3	893	2BHK	NORTH
S1,T1	884	2BHK	NORTH
S2,T2	599	1BHK	NORTH
S3,T3	764	2BHK	NORTH
S4,T4	893	2BHK	NORTH

SPECIFICATION

STRUCTURE:

RCC Framed structure with brick / ACC Block masonry and plastering.

FLLORING:

4' x 2' Vitrified tiles for floor, Toilet 7'0" Height 12"x 18" glazed wall tiles and flooring 1'0" x 1'0" antiskid tiles.

CARPENTRY:

All the Main doors are teak frame with Malaysian teak doors.

All the Inner doors are teak wood frame with water proof flush doors

Toilets are WPC frame and doors.

PLUMBING:

CPVC concealed plumbing lines for hot and cold water, all sanitary fittings are of parry ware, CP fitting are parry ware claret (or) equivalent make fitting.

ELECTRICAL:

Concealed multi standard copper orbit wiring with necessary points with Anchor Roma (or) equivalent switches. 3 phase EB connection for all flats.

PAINTING:

Emulsion paint for interior and Ace paint for exterior.

LANDMARK

1. Dhanalakshimi College - 4.6 km
2. TMG College - 1.4 km
3. Vels global school - 1.4 km
4. Chennai Outer ring road - 5.6 km
5. Vandalur Zoo & Junction - 6.7 km
6. Annai arul hospital - 3.8 km
7. Perungalathur Railway station - 4.6 km
8. Tambaram Railway station - 6.8 km
9. PTC Quarters bus stand - 350 m
10. Kalaingar bus terminus - 9.3 km
11. TCS - 8.2 km
12. Sutherland - 8.9 km
13. Accenture - 7.8 km

PAYMENT TERM

At the time of booking	1 Lakhs
At the time of agreement	20%
(within 10 days from the date of booking)	
At the time of registration	30%
(within 20 days from the date of agreement)	
On completion of foundation work	10%
On completion of respective roof slab	10%
On completion of brickwork	10%
On completion of plastering	10%
On completion of flooring work	5%
At the time completion of first coat painting	Remaining Amount

EXTRA CHARGES

1 Lakhs

- Reserved car parking
- Stamp duty & Registration fees
- 3 Phase EB connection
- Metro water, Drainage / septic tank & Assessment Charges
- GST & Other Taxes etc.

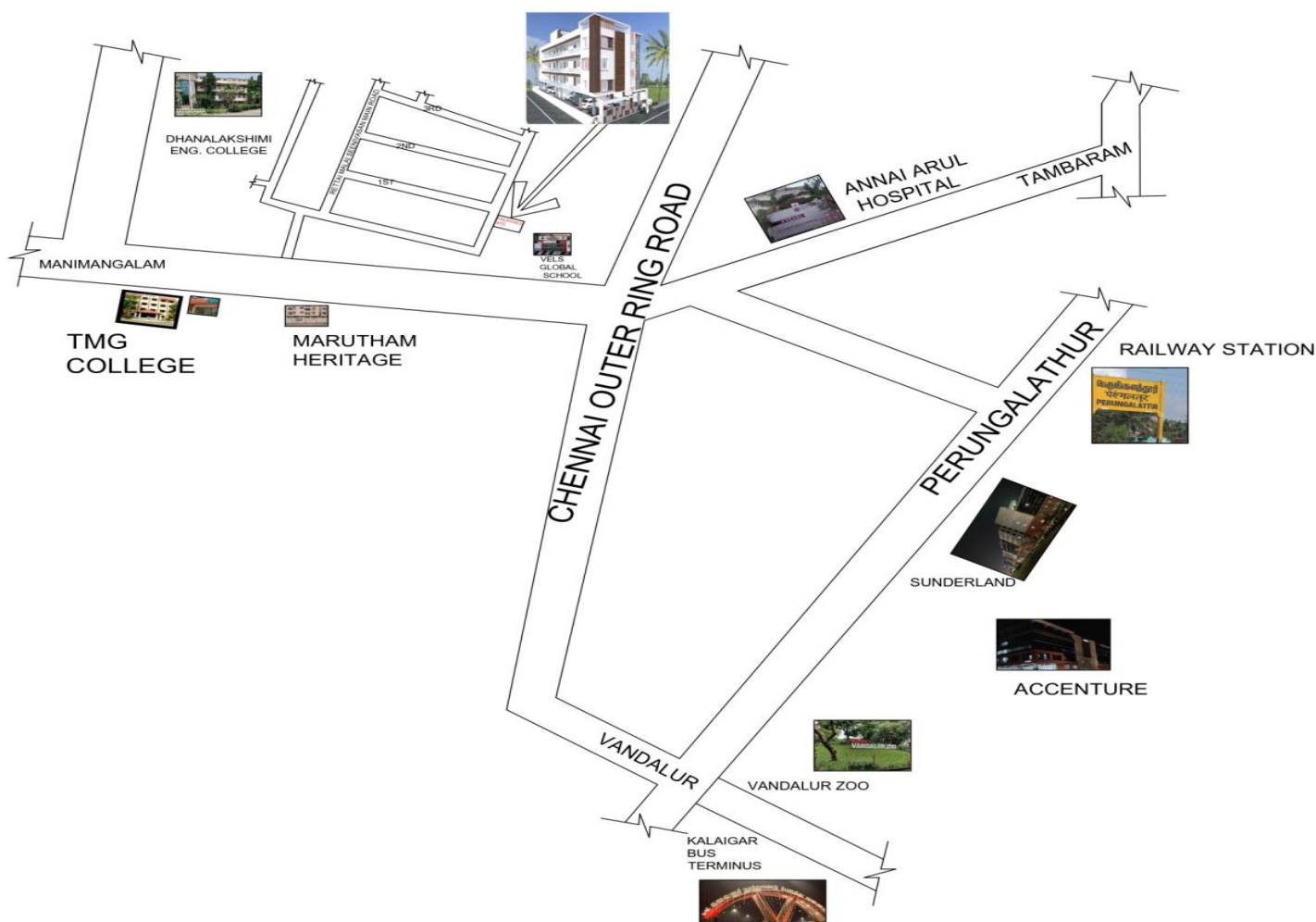

SITE ADDRESS

1st St, Vijayanagar, Varadharajapuram,
(Opposite to Marutham Heritage)
Manimangalam road
Near PTC Quarters Bus Stop

NOTE

This booklet is conceptual and not a legal offerings. The promoter reserves the right to change, alter, add or delete any of the specifications mentioned herein without prior permission or notice.

 **Shree Constructions**

BUILDING CONTRACTOR | FLAT PROMOTER | ARCHITECTS

Contact Us: 9566220055 / 9500123824
Email: marketing@shreeconstructions.com
Website: www.shreeconstructions.com